

ROOMOR WALL 5.0

30-Oct.-2018

5.0 PAR16

max. 35W | GU10 | 100-240VAC | 50-60Hz
 CE IP20 45°/45° 30°/30°

BODY COLOUR

black texture (Cable Plug with hand switch) 340120B--
 black texture (Cable base round) 340220B--

OPTIONAL

No shade 00
 SHADE 1.0
 black texture B1
 black texture + gold KI
 felt grey (max.15W) FI

for PAR16 lamps see our catalogue

SHADE 1.0

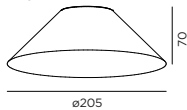

mount Shade:

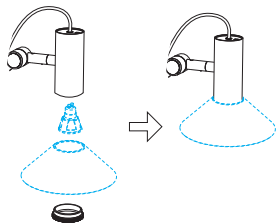

base dimensions

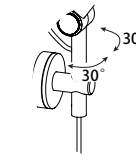
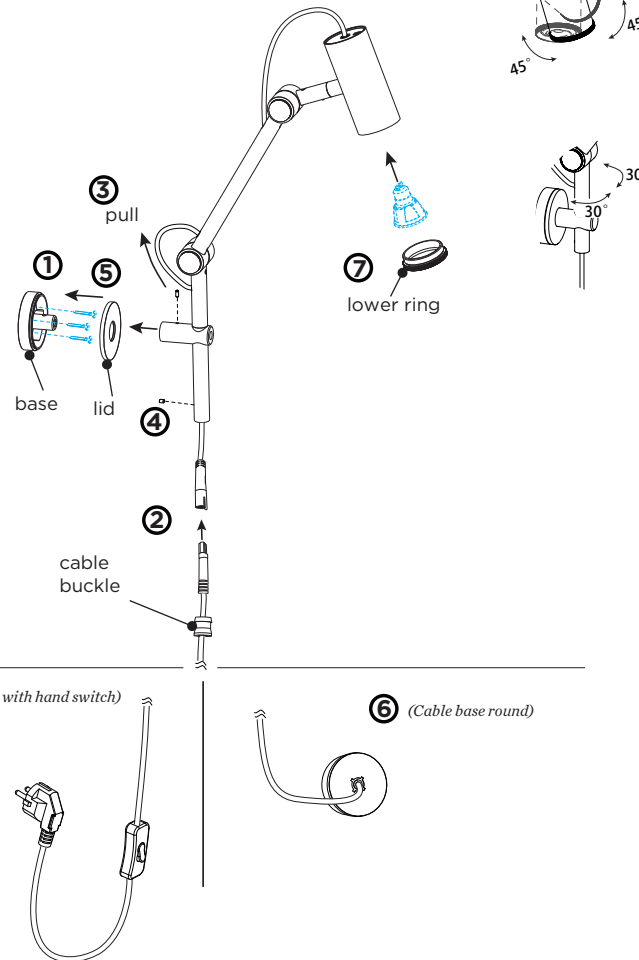
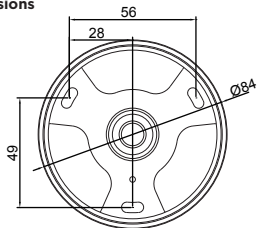

DIMENSIONS

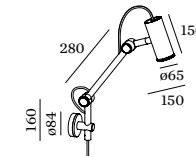

ROOMOR WALL 5.0

MOUNTING INSTRUCTION

- 1 Open the lid, and mount the base on the wall, and then close the lid by pressing.
- 2 Connect the cable plugs.
- 3 Pull the cable up so that the connected plugs can get into the tube of the luminaire body.
- 4 Put inside by pressing and fix the cable buckle with the allen screw.
- 5 Install the luminaire body on the base and fix it with the allen screw
- 6 *for Cable Plug with hand switch:*
Power connected with the plug.

for Cable base round:

Mount the round base on the wall

(You have to turn the cover counterclockwise a quarter in order to loosen it from the base and mounting back on is by turning clockwise.)

POWER CONNECTION

Connect the wires
 connection: STANDARD version

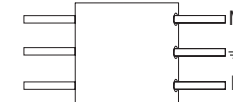

- 7 Unscrew the lower ring of the luminaire body, install a bulb (bulb is not included), and then screw the lower ring back.



WEVER & DUCRÉ
 LIGHTING

www.weverducre.com

Wever & Ducre bvba Spinnerijstraat 99/21 8500 Kortrijk

INSTALLATION
 INSTRUCTIONS