

DRO WALL COMP

16-Feb.-2019

1.0

3xLED QT14 max. 3W | G9 | 220-240VAC | 50-60Hz

CE IP20

COLOUR

black mounting+white opal glass

3441G0WB0

black mounting+brown opal glass

3441G0YB0

OPTIONAL LAMP:

QT14 LED opal | 2700K | 170lm

9019G706

more lamps see our catalogue

base dimensions

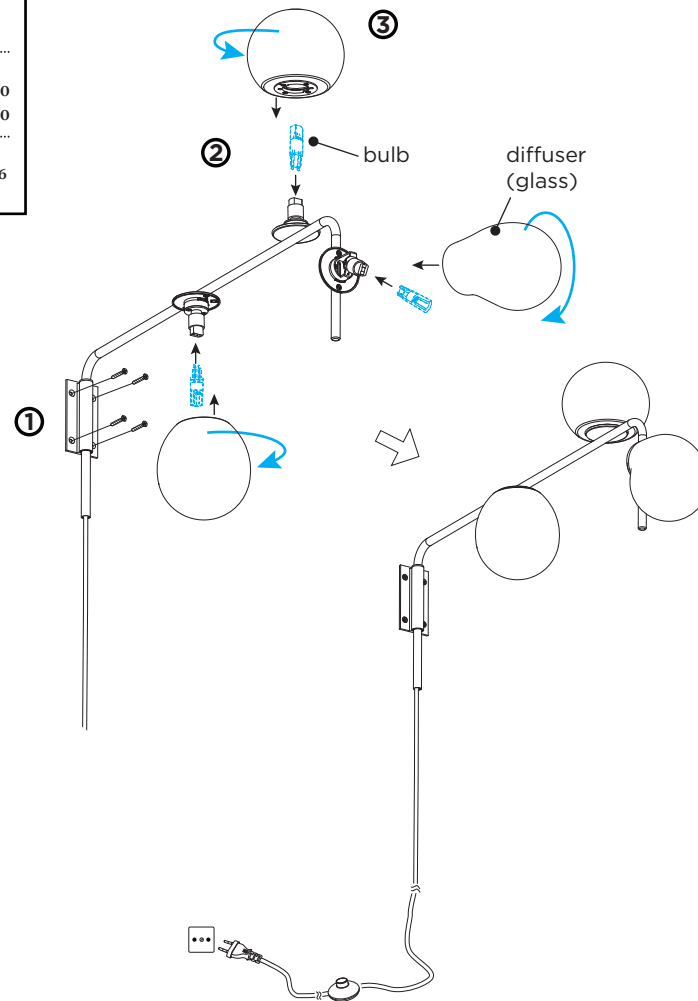
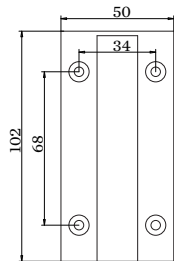

DIMENSIONS

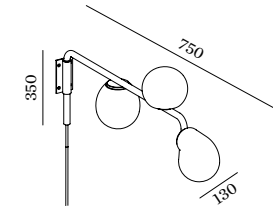

1.0 COMP

MOUNTING INSTRUCTION

- 1 Mount the luminaire on the wall with the screws. (screws are included)
- 2 Install bulbs (bulbs are not included).
- 3 Mount the diffusers.
 - a Use a diffuser to cover the base.
Notice: Keep the grooves of the diffuser aligned with the projecting positions of the base.
 - b Then hold the diffuser and clockwise rotating till lock position. (The angle of rotation is about 90°)



WEVER & DUCRÉ
LIGHTING

www.weverducre.com

Wever & Ducre bvba Spinnerijstraat 99/21 8500 Kortrijk

INSTALLATION
INSTRUCTIONS