

SELO

20-Apr.-2016

1.0

LED 8W | 220-240VAC | PCB 3-step | ambient white dim | 1800-2850K

CE IP20 0.3m

porcelain white

232189W9

2.0

LED 8W | 220-240VAC | PCB 3-step | ambient white dim | 1800-2850K

CE IP20 0.3m

porcelain white

232289W9

3.0

LED 8W | 220-240VAC | PCB 3-step | ambient white dim | 1800-2850K

CE IP20 0.3m

porcelain white

232389W9

OPTIONAL

single ceiling base
multi ceiling bases

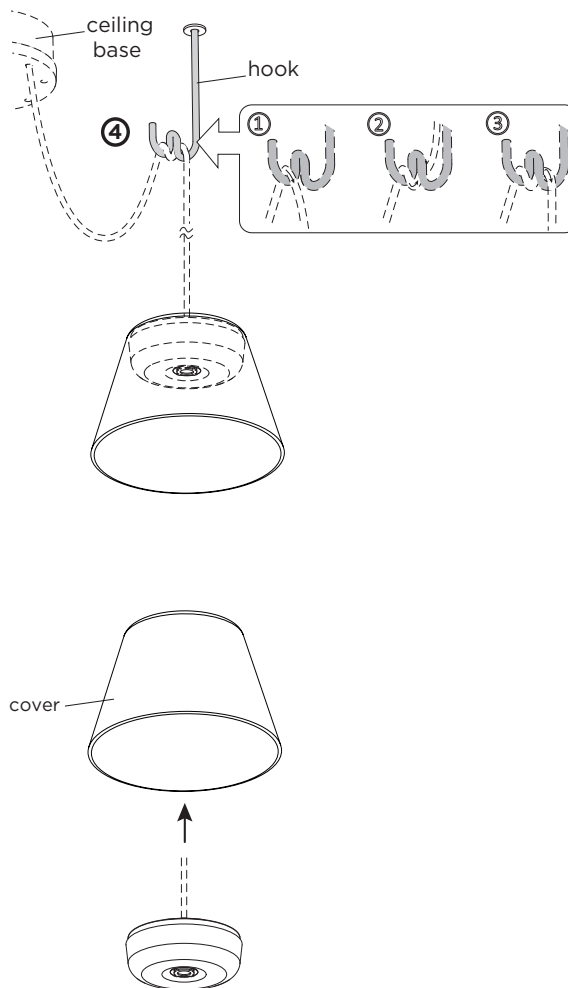

DIMENSIONS

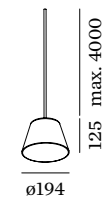

SELO 1.0

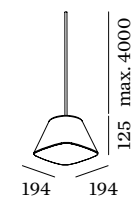

SELO 2.0

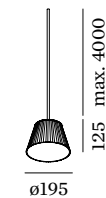

SELO 3.0

MOUNTING INSTRUCTION

- 1 Let the cable pass through the hole on the cover top.

POWER CONNECTION

- 2 Connect the power supply connection: STANDARD version

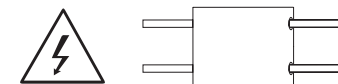

- 3 Hang the cable on the hook.



WEVER & DUCRÉ
LIGHTING

www.weverducre.com

Wever & Ducre bvba Kwadestraat 153 bus 2.1 8800 Roeselare

INSTALLATION
INSTRUCTIONS