

ROOMOR CEILING 1.0

16-Feb.-2019

1.0 PAR16

max. 35W | GU10 | 100-240VAC | 50-60Hz
 CE IP20 45°/45°

MOUNTING COLOUR

black texture

168120B_..

1.0 E27

LED QA60 max. 12W | E27 | 220-240VAC | 50-60Hz
 CE IP20 45°/45°

MOUNTING COLOUR

black texture

1681E0B_..

OPTIONAL

Extension Tube
 0.5 m
 1 m

90019192

90019191

No shade

00

SHADE 1.0

black texture B1
 black texture + gold K1
 felt grey (max.15W) F1

SHADE 2.0

black texture B2
 black texture + gold K2
 felt grey (max.15W) F2

SHADE 3.0

black texture B3
 black texture + gold K3
 felt grey (max.15W) F3

SHADE 4.0

black texture B4
 black texture + gold K4
 felt grey (max.15W) F4

for lamps see our catalogue

SHADE 1.0



SHADE 2.0

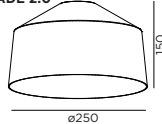

SHADE 3.0

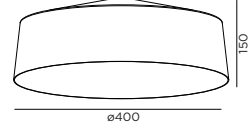

SHADE 4.0

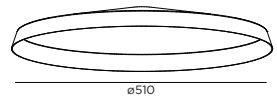

base plate dimension:

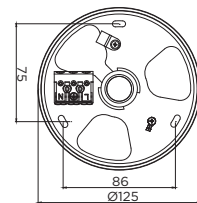

mount Shade:

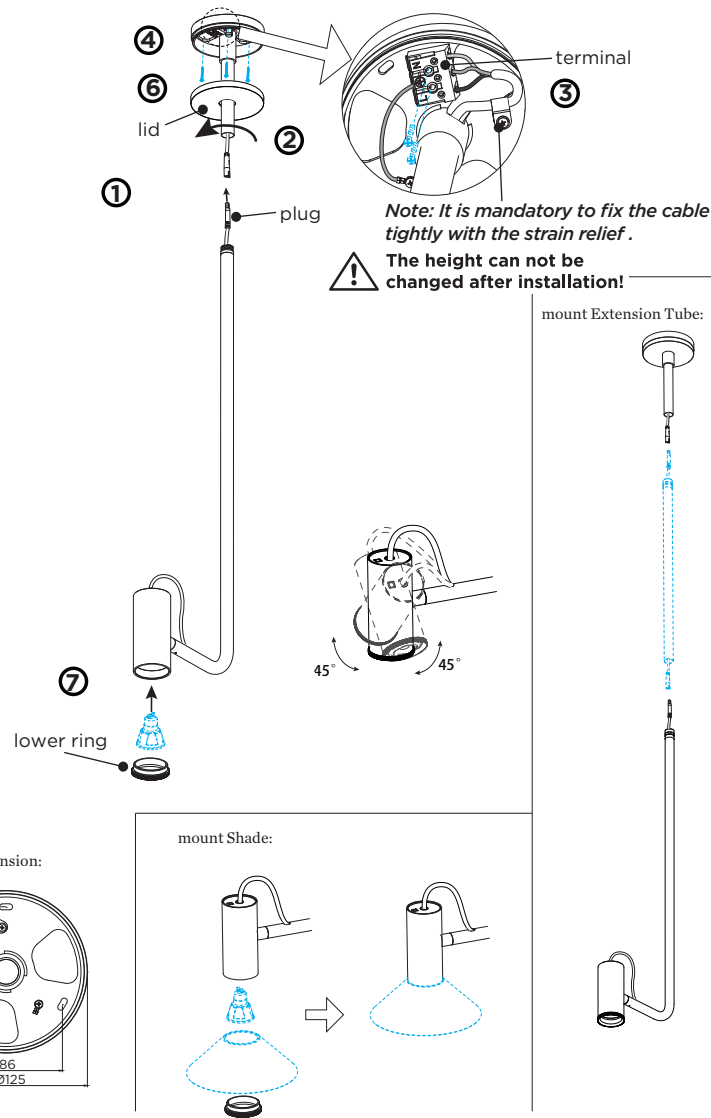
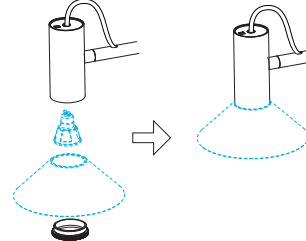

DIMENSIONS

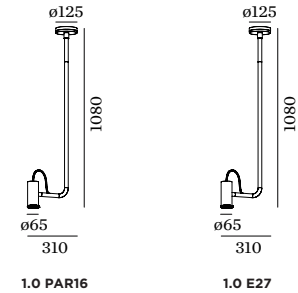

MOUNTING INSTRUCTION

- Connect the cable plugs;
- Mount the ceiling base on the luminaire by rotating.
- Open the lid, and fix the terminal in the base with two screws.
- mount the base on the ceiling with 3 screws.

POWER CONNECTION

- Connect the power

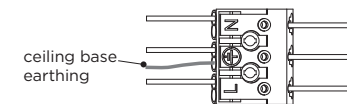

- Close the lid of ceiling base by pressing.
- Unscrew the lower ring of the luminaire body, install a bulb (bulb is not included), and then screw the lower ring back.

PB19-010-596-00



WEVER & DUCRÉ
 LIGHTING

www.weverducre.com

Wever & Ducre bvba Spinnerijstraat 99/21 8500 Kortrijk

INSTALLATION
 INSTRUCTIONS