

# CORK MULTI CEILING BASE ROUND

18-May-2016

CE IP20

White texture  
Black texture

90052015  
90052016

mounting plate dimension:

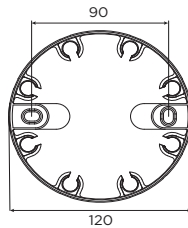

①

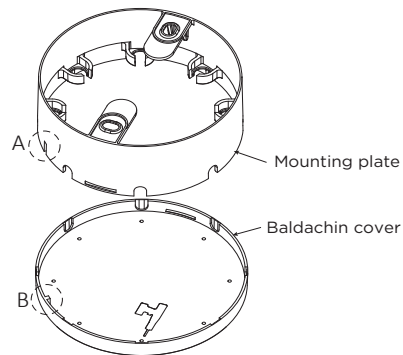

**WARNING:** the slot A and raised section B should be aligned when installation.

## Wiring method 1:

(Check page 2 for overall view details)

②

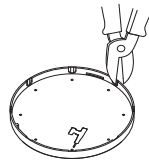

④

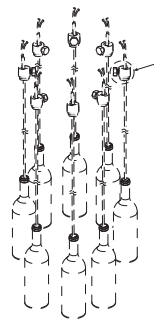

⑥

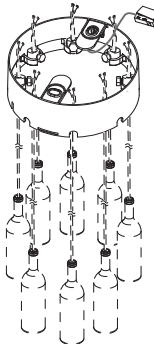

## Wiring method 2:

③

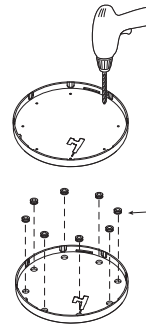

strain relief

adjusting knob

When the cable length is determined, please remember to tighten it.

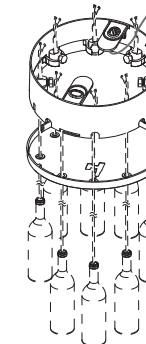
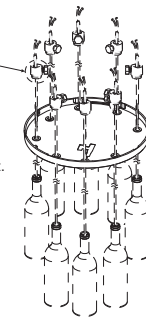

## DIMENSIONS

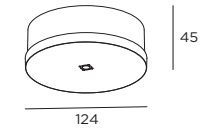

## MOUNTING INSTRUCTION

- ① Remove the mounting plate from the baldachin cover. Fix the mounting plate on the ceiling with screws.
- \* **There are two wiring method:**  
Method 1: the lamp cables go through the wall of the Mounting plate;  
Method 2: the lamp cables go through the bottom of the Baldachin cover.
- ② Make holes on the Baldachin cover for lamp cables.
- ③ Put the grommets into the holes. (This step applies to the Method 2. )
- ④ Adjust the cables of luminaire to desired length, tighten the strain reliefs
- ⑤ **POWER CONNECTION**

Min 3 LAMPS  
Max 8 LAMPS

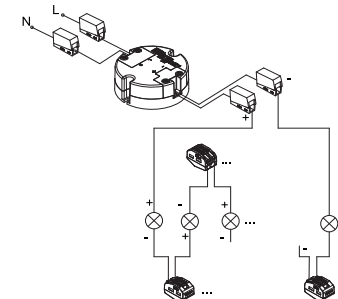

Baldachin cover earthing connector:



- ⑥ Hang the strain reliefs on the holders.



**WEVER & DUCRÉ**  
LIGHTING

[www.weverducre.com](http://www.weverducre.com)

Wever & Ducre bvba Kwadestraat 153 bus 2.1 8800 Roeselare

**INSTALLATION  
INSTRUCTIONS**

PAGE 1/2

# CORK MULTI CEILING BASE ROUND

18-May-2016

## Wiring method 1:

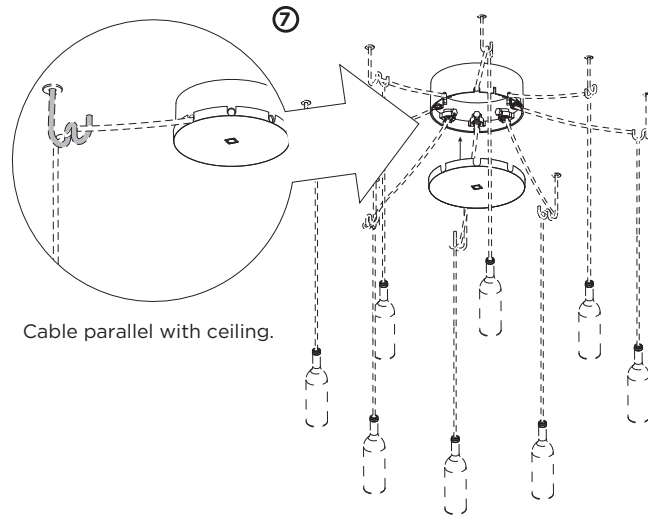

## Wiring method 2:

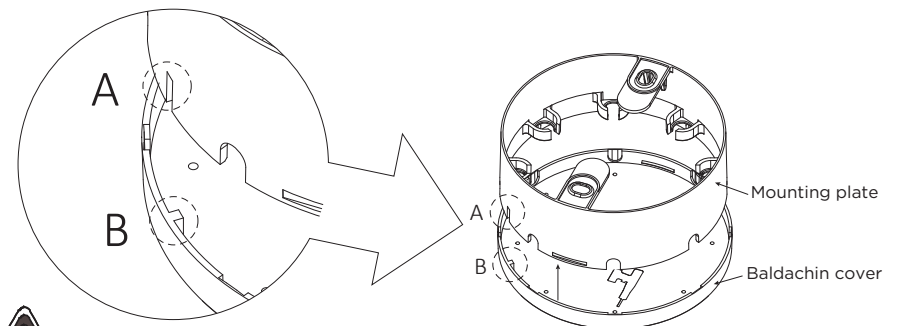
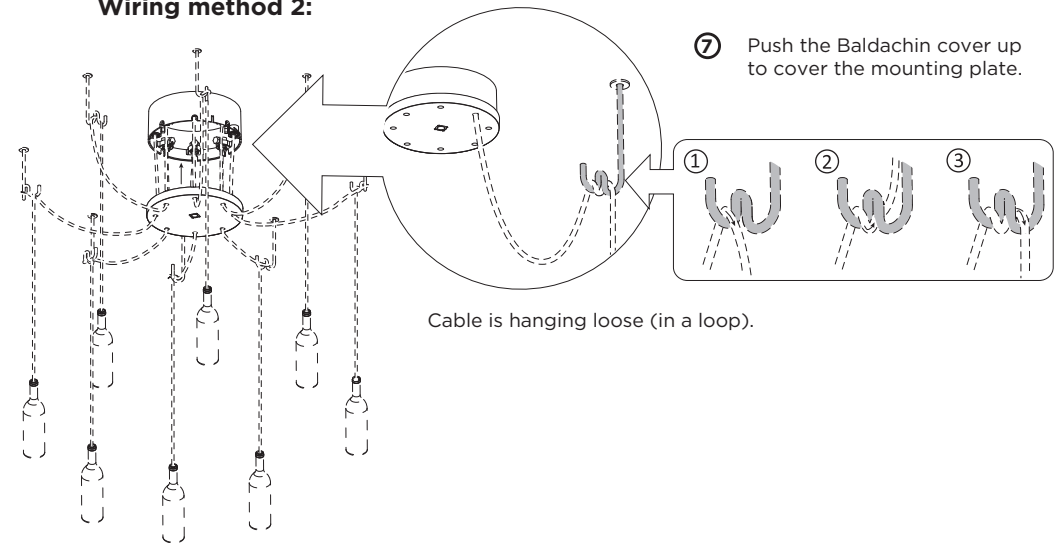

**WARNING:** When push the baldachin cover up to the mounting plate, please make sure the slot A and raised section B are aligned.

# BALDACHIN

17-Oct.-2016

## 600MM

CE IP20

White texture  
Black texture

90052017  
90052018

mounting plate dimension:

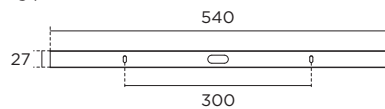

①

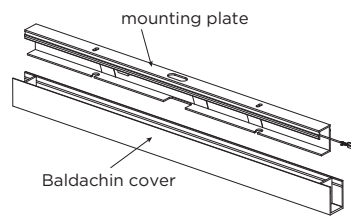

②

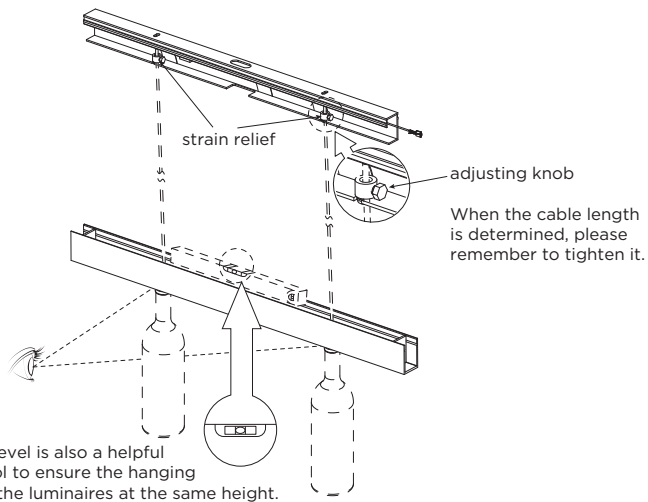

③

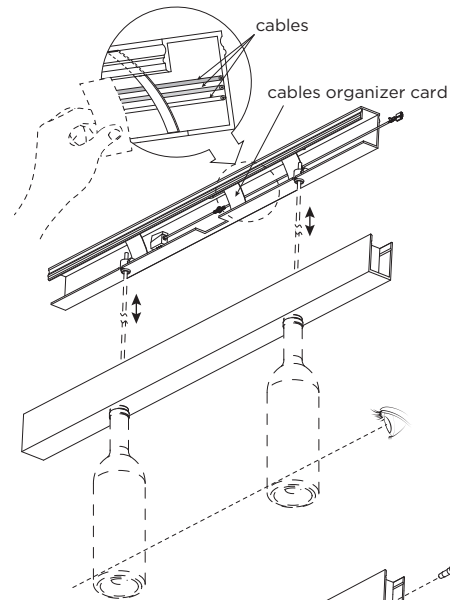

⑤

⑥

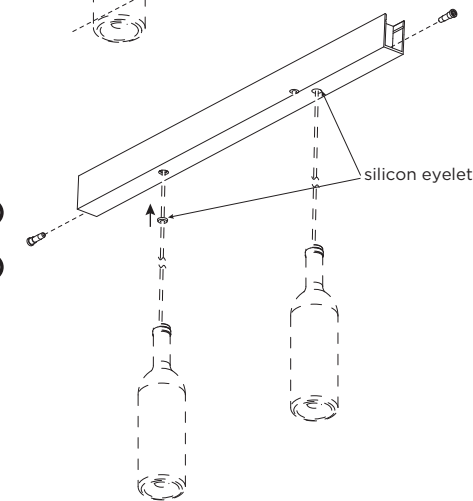

## DIMENSIONS

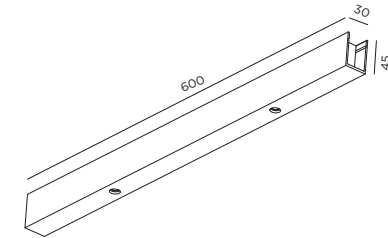

## MOUNTING INSTRUCTION

- ① Remove the mounting plate from the baldachin cover.
- ② Adjust the cable of lights to desired length. If you need the lights be horizontal alignment, the baldachin cover can be a helpful judgement tool.
- ③ Fix the mounting plate on the ceiling with screws. If you need to align the orientation of the light, fine-tuning of strain relief direction to achieve adjustment.

## ④ POWER CONNECTION

Connect the power

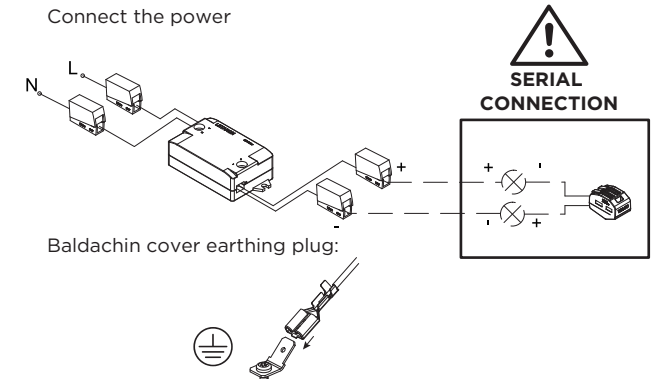

- ⑤ Lock the baldachin cover on the mounting plate with two plastic screws.
- ⑥ Put the silicon eyelets in the cable outlets.



WEVER & DUCRÉ  
LIGHTING

www.weverducre.com

INSTALLATION  
INSTRUCTIONS

# BALDACHIN

27-Jul.-2016

## 900MM

CE IP20

White texture  
Black texture

90052019  
90052020

mounting plate dimension:

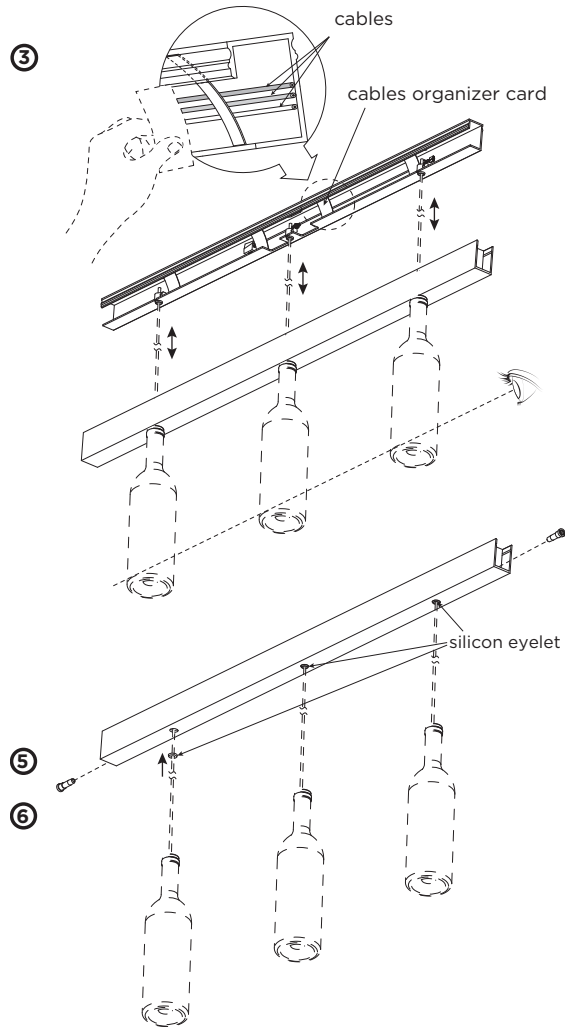
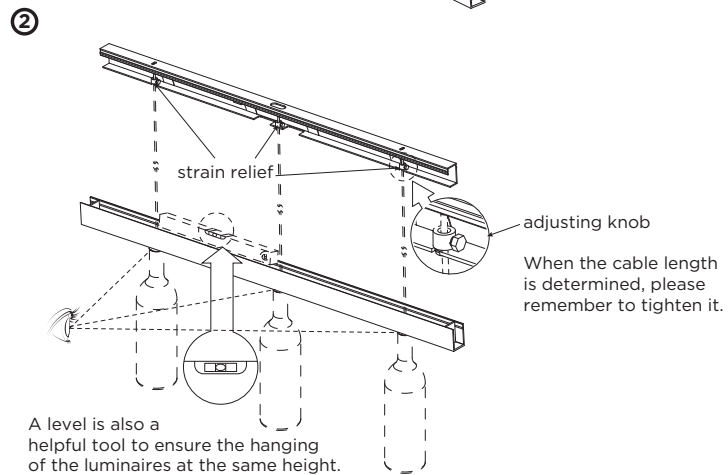
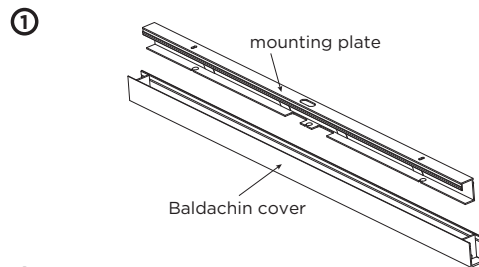
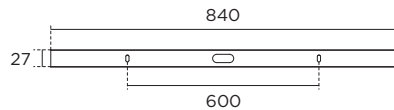

## DIMENSIONS

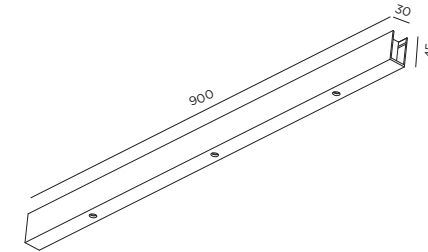

## MOUNTING INSTRUCTION

- ① Remove the mounting plate from the baldachin cover.
- ② Adjust the cable of lights to desired length. If you need the lights be horizontal alignment, the baldachin cover can be a helpful judgement tool.
- ③ Fix the mounting plate on the ceiling with screws. If you need to align the orientation of the light, fine-tuning of strain relief direction to achieve adjustment.

## ④ POWER CONNECTION

Connect the power

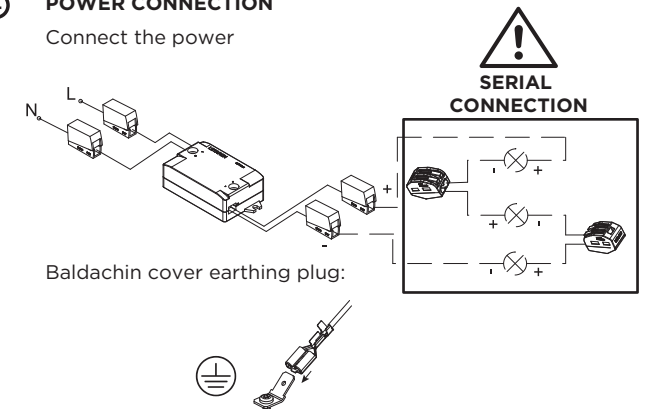

- ⑤ Lock the baldachin cover on the mounting plate with two plastic screws.
- ⑥ Put the silicon eyelets in the cable outlets.



WEVER & DUCRÉ  
LIGHTING

www.weverducre.com

INSTALLATION  
INSTRUCTIONS