

# BEBOW

27-Feb.-2020

## 1.0

**LED** 35W | 220-240VAC | 50-60Hz | PCB 3-step | incl. PS | phase-cut dim  
opal cover | two circuits

CE IP20 0.3m

3000K | >90CRI | 1820lm  
white texture  
black texture

132184W5  
132184B5

## 2.0

**LED** 55W | 220-240VAC | 50-60Hz | PCB 3-step | incl. PS | phase-cut dim  
opal cover + 3x spot | two circuits

CE IP20 0.3m

3000K | >90CRI | 2650lm  
white texture  
black texture

132164W5  
132164B5

top view

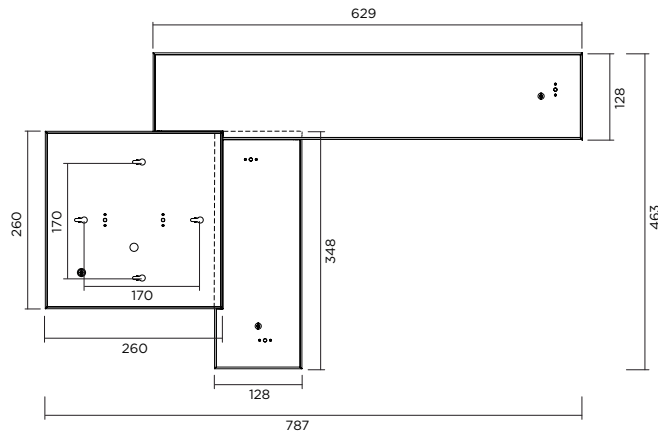

side view

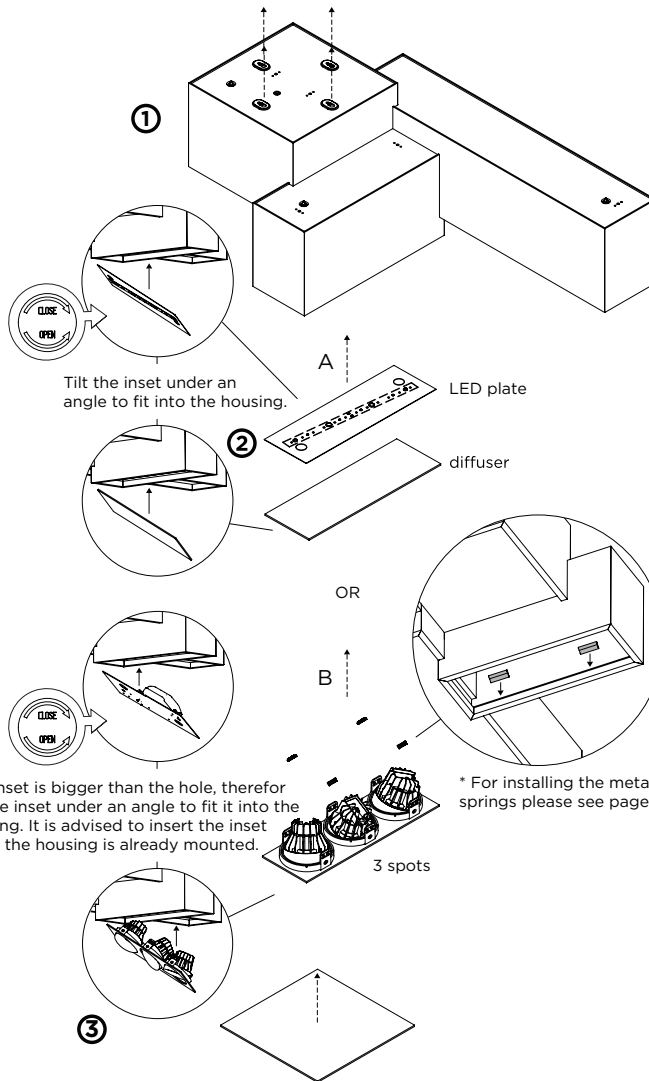
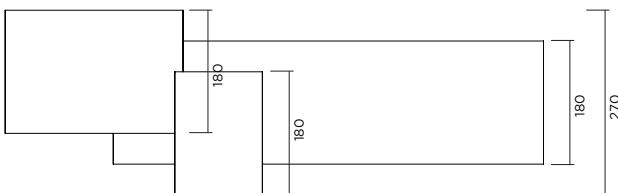

## DIMENSIONS

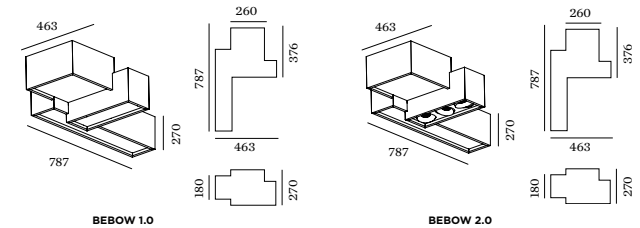

## ① MOUNTING INSTRUCTION

Remove the diffuser of the square part and mount the Below to the ceiling with 4 screws.

## ② POWER CONNECTION

Connect the complete fixture to 220-240V  
Please see the connection wiring diagram A on page 3.

middle area

A - Opal diffuser

Connect the inner LED-plate to the base of the middle part. Turn the buttons inside of the middle area to lock the LED plate to the base. Close the middle area with the diffuser.

B - Spots

Before mounting the spots click the 4 metal springs by hand into the small recessed groove\*. Connect the 3 spots to the drivers and then insert into the middle area.

See serial connection wiring scheme below.

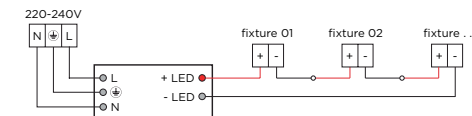

NOTE:

There is a possibility to make a separate circuit for the middle area for separate switching.

Please see the connection wiring diagram B on page 3.

③ Insert the diffuser of the square part back into the Below.



WEVER & DUCRÉ  
LIGHTING

www.weverducre.com

Wever & Ducre bvba Spinnerijstraat 99/21 8500 Kortrijk

INSTALLATION  
INSTRUCTIONS

PAGE 1/4

# BEBOW

27-Feb.-2020

## 1.0

**LED** 35W | 220-240VAC | 50-60Hz | PCB 3-step | incl. PS | phase-cut dim  
opal cover | two circuits

CE IP20 0.3m

3000K | >90CRI | 1820lm  
white texture  
black texture

132384W5  
132384B5

## 2.0

**LED** 55W | 220-240VAC | 50-60Hz | PCB 3-step | incl. PS | phase-cut dim  
opal cover + 3x spot | two circuits

CE IP20 0.3m

3000K | >90CRI | 2650lm  
white texture  
black texture

132364W5  
132364B5

top view

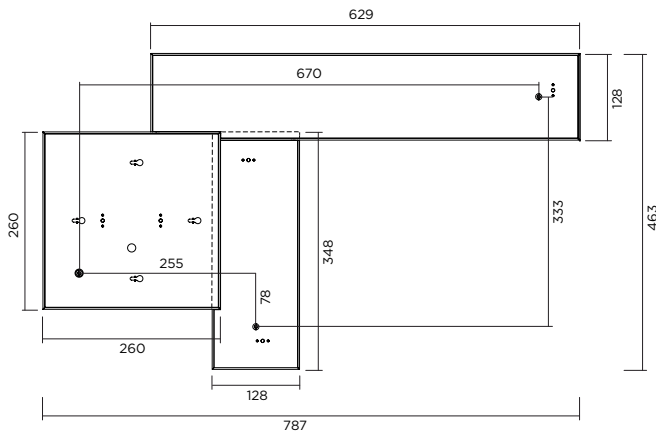

side view

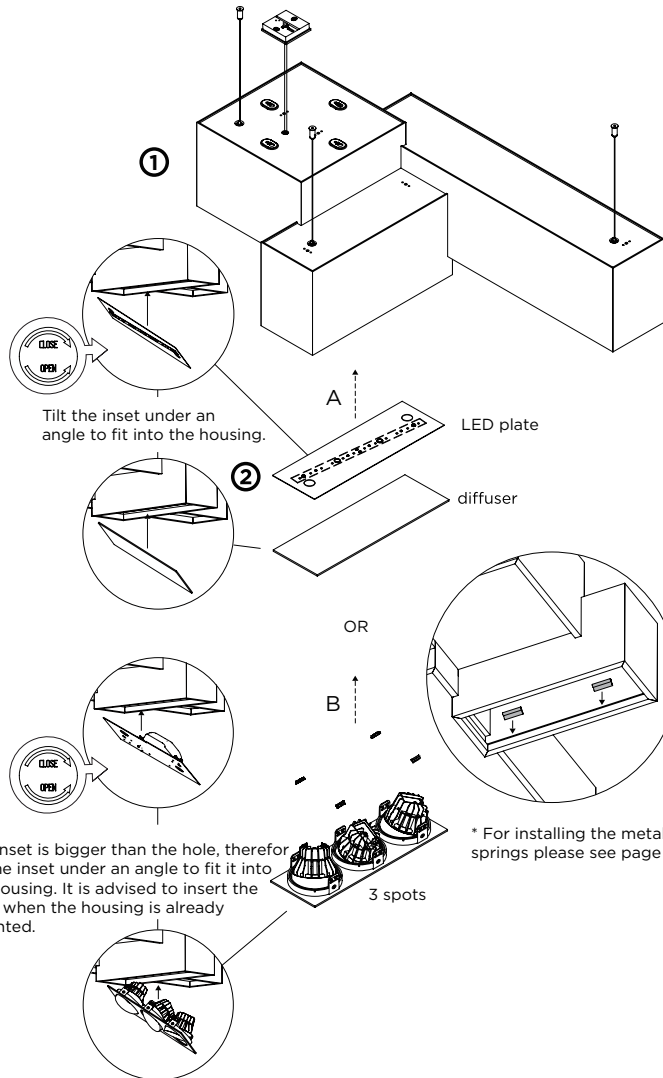
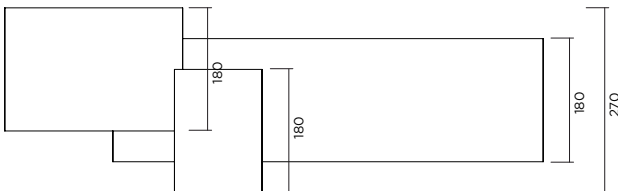

## DIMENSIONS

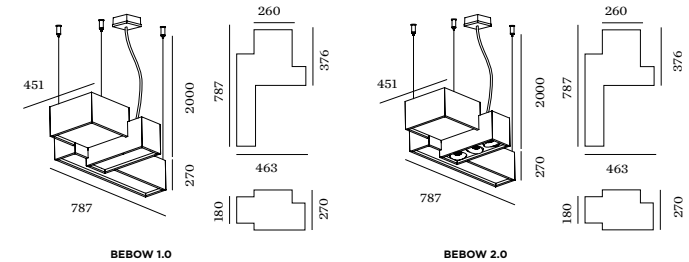

## 1 MOUNTING INSTRUCTION

Attach the Bebow to the ceiling with the 3 suspension wireropes.

## 2 POWER CONNECTION

Connect the complete fixture to 220-240V  
Please see the connection wiring diagram A on page 3.

middle area

A - Opal diffuser

Connect the inner LED-plate to the base of the middle part. Turn the buttons inside of the middle area to lock the LED plate to the base. Close the middle area with the diffuser.

B - Spots

Before mounting the spots click the 4 metal springs by hand into the small recessed groove\*. Connect the 3 spots to the drivers and then insert into the middle area.

See serial connection wiring scheme below.

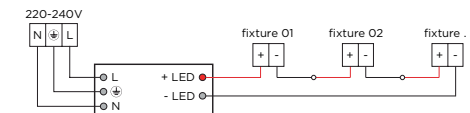

NOTE:

There is a possibility to make a separate circuit for the middle area for separate switching.

Please see the connection wiring diagram B on page 3.



WEVER & DUCRÉ  
LIGHTING

www.weverducre.com

Wever & Ducre bvba Spinnerijstraat 99/21 8500 Kortrijk

INSTALLATION  
INSTRUCTIONS

PAGE 2/4

# BEBOW

27-Feb.-2020

wiring diagram A:

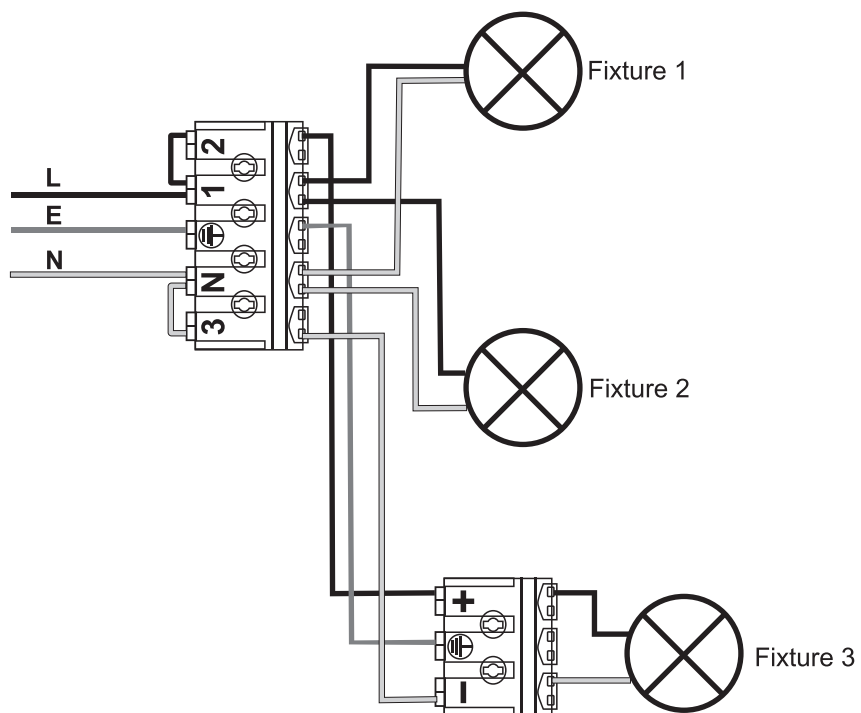

wiring diagram B:

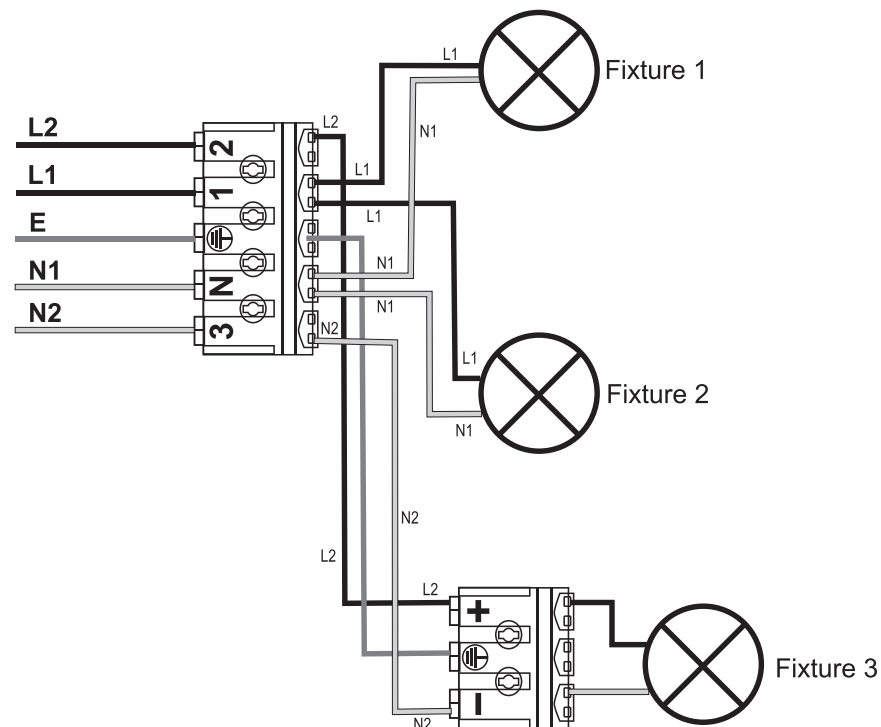

# BEBOW

27-Feb.-2020

## \* INSTALLATION OF THE METAL SPRINGS.

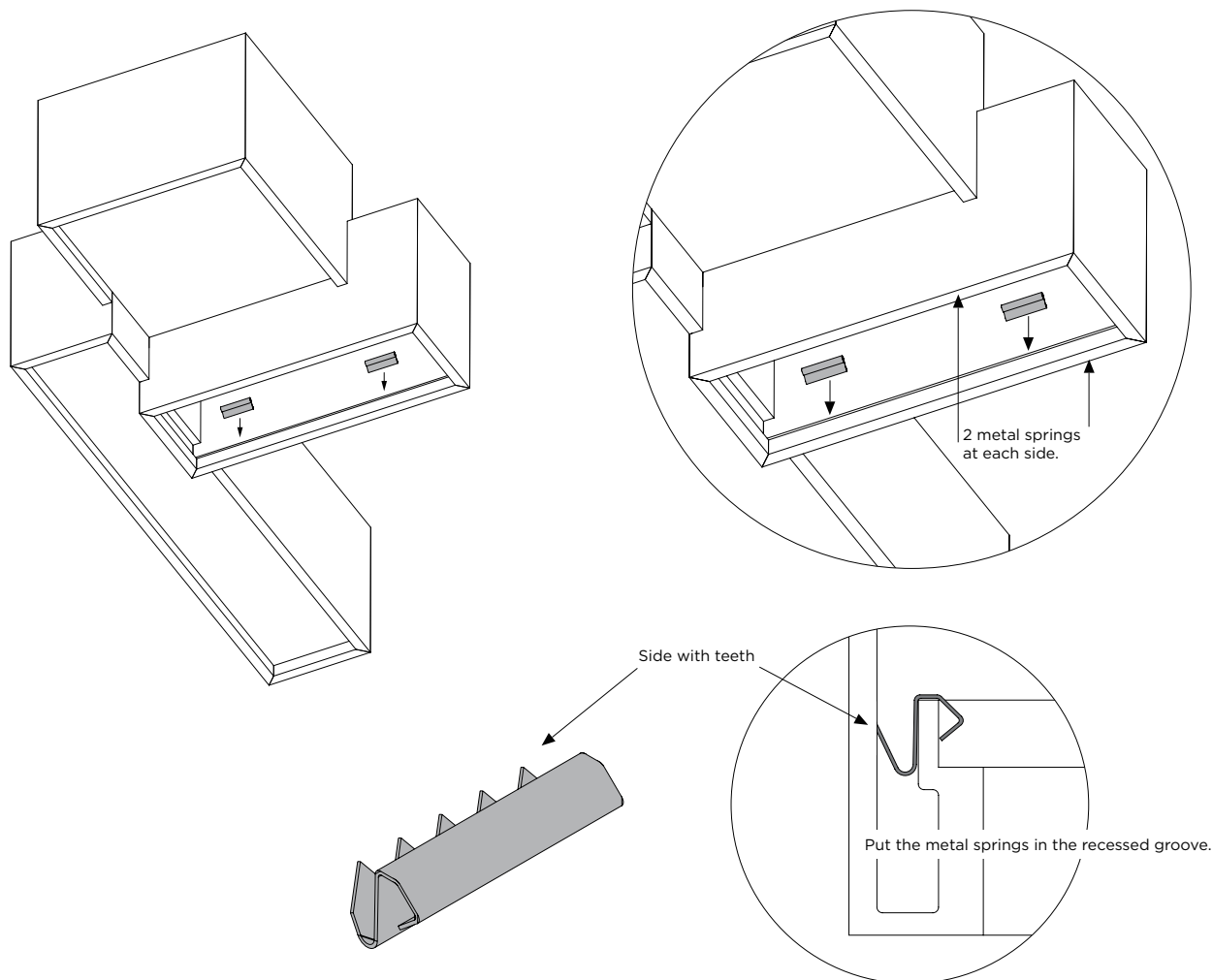

Click the 4 metal springs by hand into the small recessed groove as shown. The side with teeth should touch the inner wall of the Bebow.

### BEBOW 1.0

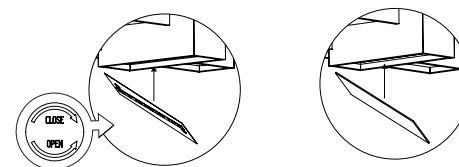

When the 4 metal springs are fixed in the recessed groove, the LED plate and opal diffuser can be installed. It is advised to first mount the Bebow housing to the ceiling and install the LED plate and opal diffuser next. Tilt both components under an angle to fit them into the housing as shown.

### BEBOW 2.0

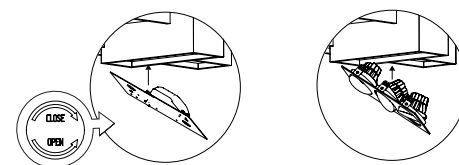

When the 4 metal springs are fixed in the recessed groove, the driver and spot inset can be installed. It is advised to first mount the Bebow housing to the ceiling and install the driver and spot inset next. Tilt both components under an angle to fit them into the housing as shown.