

SIRRO

03-Aug-2018

3.0 LED - ceiling surfaced

LED 3x10W | 220-240VAC | 50-60Hz | COB 3-step | incl. PS | phase-cut dim

CE IP20 10,3m 36° 35°/35° 355°

white texture	139364W_
white texture + black	139364E_
aluminium brushed + black	139364F_
black texture	139264B_

LIGHT COLOUR

2700K >90CRI 590lm	3
3000K >90CRI 640lm	5
1800-2850K >95CRI 440lm	9

3.0 PAR16 - ceiling surfaced

3xPAR16 max. 35W | GU10 | 100-240VAC | 50-60Hz

CE IP20 10,3m 35°/35° 355°

white texture	139320W0
white texture + black	139320E0
aluminium brushed + black	139320F0
black texture	139320B0

OPTIONAL

for PAR16 lamps see our catalogue

3.0 LED - suspended

LED 3x10W | 220-240VAC | 50-60Hz | COB 3-step | incl. PS | phase-cut dim

CE IP20 10,3m 36° 35°/35° 355°

white texture	139764W_
white texture + black	139764E_
aluminium brushed + black	139764F_
black texture	139764B_

LIGHT COLOUR

2700K >90CRI 590lm	3
3000K >90CRI 640lm	5
1800-2850K >95CRI 440lm	9

3.0 PAR16 - suspended

3xPAR16 max. 35W | GU10 | 100-240VAC | 50-60Hz

CE IP20 10,3m 35°/35° 355°

white texture	139720W0
white texture + black	139720E0
aluminium brushed + black	139720F0
black texture	139720B0

OPTIONAL

for PAR16 lamps see our catalogue

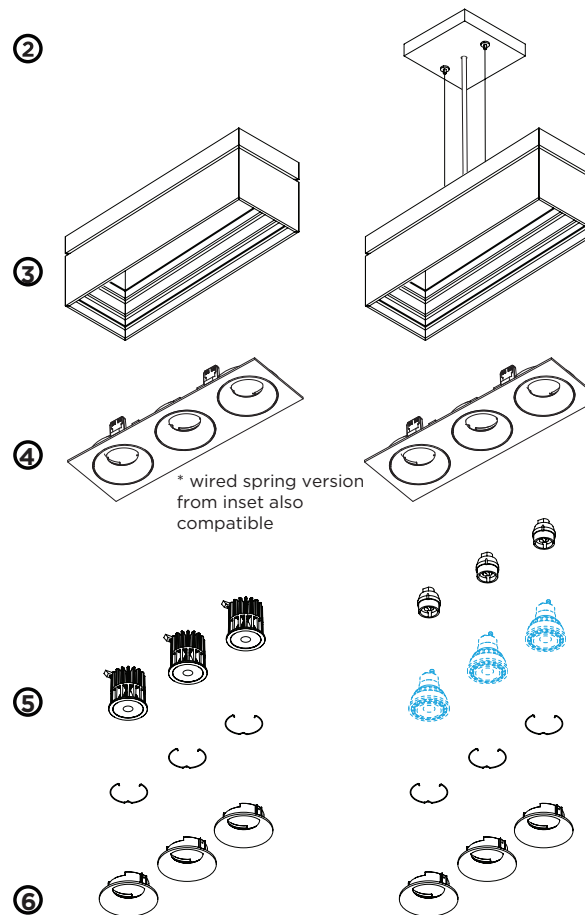

* wired spring version from inset also compatible

DIMENSIONS

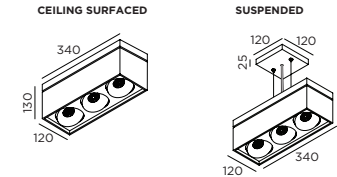

MOUNTING INSTRUCTION

POWER CONNECTION

- 1 PARALLEL CONNECTION - for LED and PAR16

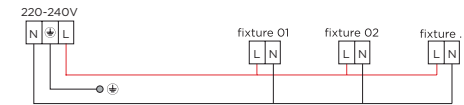

- 2 Mount the ceiling base on the ceiling
- 3 Attach the SIRRO to the ceiling base (in case of surfaced version)
- 4 Insert the outer part of the inset module into the SIRRO
- 5 Insert the lamps into the inner parts of the inset module
- 6 Click the inner part of the inset module into the outer part

