

# RON

17-May-2016

## 1.0 LED

**LED** 7/10W | 350-500mA | COB 3-step | excl. power supply  
 CE P20 960°C 0,3m 35°/35° 355°

white texture	111161W_
black texture	111161B_
white texture (blade springs)	111161W_C

### LIGHT COLOUR

2700K   >90CRI   420-590lm   18Vf	3
3000K   >90CRI   470-640lm   18Vf	5
1800-2850K   >90CRI   320-440lm   18Vf	9

### ALWAYS USE

for power supplies see our catalogue

## 1.0 MR16

QR-CBC51 max. 50W | GU5.3 | 12V | excl. transformer  
 CE P20 960°C 0,9m 35°/35° 355° DO NOT COVER WITH INSULATION

white texture	111110W0
silver / grey	111110S0
black texture	111110B0
white texture (blade springs)	111110W0C

### ALWAYS USE

for transformers see our catalogue

## 1.0 PAR16

PAR16 max. 50W | GU10 | 220-240VAC | 50-60Hz  
 CE P20 960°C 0,9m 35°/35° 355° DO NOT COVER WITH INSULATION

white texture	111120W0
silver / grey	111120S0
black texture	111120B0
white texture (blade springs)	111120W0C

### ALWAYS USE

for PAR16 lamps see our catalogue

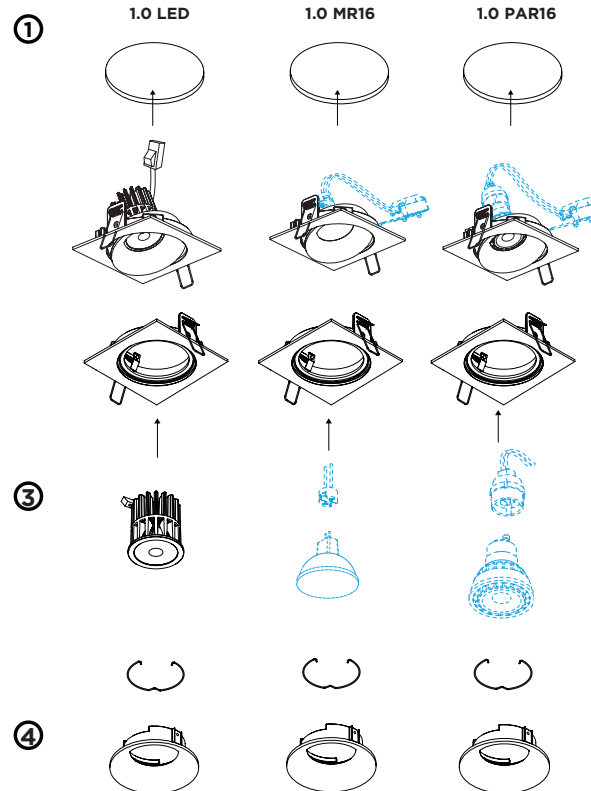

## DIMENSIONS

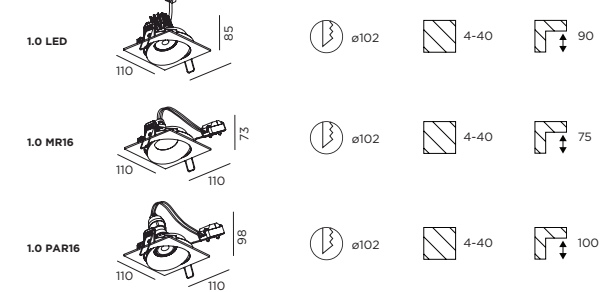

## MOUNTING INSTRUCTION

- 1 Make a hole in the ceiling according to the prescribed dimensions.

## POWER CONNECTION

- 2 SERIAL CONNECTION - for LED

**Always use POWER SUPPLY according to the specifications of the LED-module**

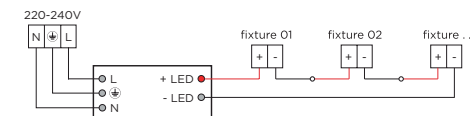

## PARALLEL CONNECTION - for MR16

**Always use 12V TRANSFORMER**

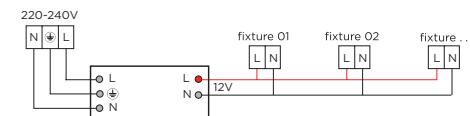

## PARALLEL CONNECTION - for PAR16

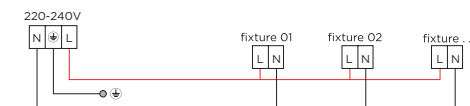

- 3 Insert the lamp into the inner part of the RON
- 4 Click the inner part of the RON into the outer part



WEVER & DUCRÉ  
LIGHTING

www.weverducre.com

Wever & Ducre bvba Kwadestraat 153 bus 2.1 8800 Roeselare

**INSTALLATION  
INSTRUCTIONS**