

# TRAIN NARROW

04-Jul.-2019

## 1.0 NARROW

LED 6W | 220-240VAC | 50-60Hz | incl.power supply

CE IP65 960° 0,3m

3000K | >80CRI | 120lm

dark grey texture

719143D4

## 2.0 NARROW UP DOWN

LED 2x3W | 220-240VAC | 50-60Hz | incl.power supply

CE IP65 960° 0,3m

3000K | >80CRI | 2x120lm

dark grey texture

719243D4

## 2.0 NARROW UP FLOOD DOWN

LED 2x3W | 220-240VAC | 50-60Hz | incl.power supply

CE IP65 960° 0,3m

3000K | >80CRI | N:120lm/F:190lm

dark grey texture

719253D4

TRAIN 1.0 - wall base dimensions

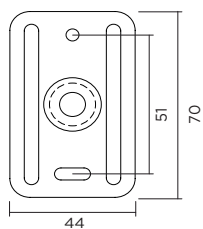

TRAIN 2.0 - wall base dimensions

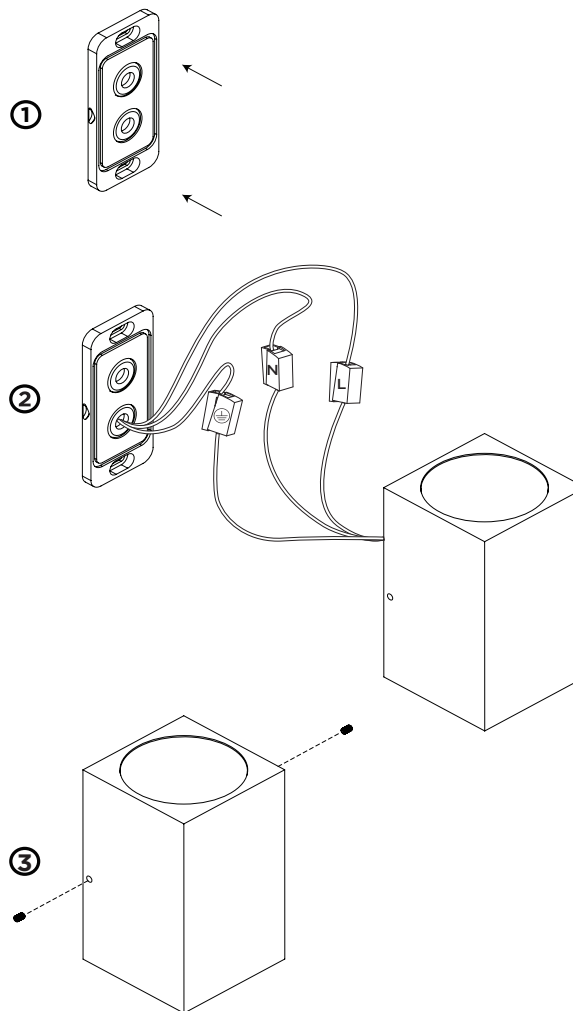
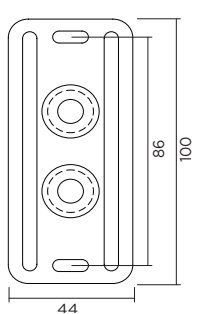

## DIMENSIONS

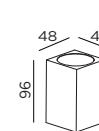

TRAIN 1.0  
NARROW

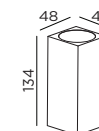

TRAIN 2.0  
NARROW UP DOWN

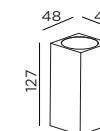

TRAIN 2.0  
NARROW UP FLOOD DOWN

## MOUNTING INSTRUCTION

- 1 Attach the wall base on the wall with screws

## POWER CONNECTION

- 2 Make connection with the power supply

Interior: STANDARD version

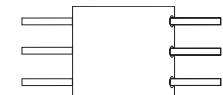

IP-rated connections for wall fixtures: cable isolation for round cables  $\varnothing$  4.5-7.5 mm, should be in the grommet. For cable use  $\varnothing$  7.0-9.5 mm: replace the grommet with the other grommet in the bag.

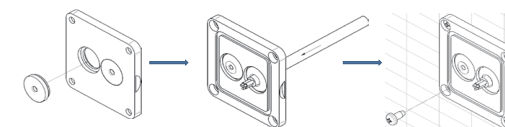

Push the grommet into the back plate.

Pull the cable through the back plate.

Mount the back plate on the wall.

- 3 Attach the TRAIN on the wall base with the side screws



WEVER & DUCRÉ  
LIGHTING

www.weverducre.com

Wever & Ducré bvba Spinnerijstraat 99/21 8500 Kortrijk

INSTALLATION  
INSTRUCTIONS