

# PALLUZ C

07-Sep-2017

## 1.0

**LED** 8W | 220-240VAC | 50-60Hz | PCB 3-step | incl. PS | phase-cut dim

CE  $\oplus$  IP65  $\text{\textcircled{90}^\circ\text{C}}$   $\text{\textcircled{1}0.3m}$   $\text{\textcircled{P}}$   $\text{\textcircled{▶}}$

3000K | >80CRI | 665lm | opal glass  
dark grey texture

724374D4

### ALWAYS USE

base 230 910033D0  
base 600 910036D0  
base 800 910038D0  
invisible fixation base 230 910032D0

### OPTIONAL, (ORDER SEPARATELY)

ground spike for invisible base 230 90013104  
ground fixation for base 230 | 600 | 800 90013303

## 2.0

**LED** 8W | 220-240VAC | 50-60Hz | PCB 3-step | incl. PS | phase-cut dim

CE  $\oplus$  IP65  $\text{\textcircled{90}^\circ\text{C}}$   $\text{\textcircled{1}0.3m}$   $\text{\textcircled{P}}$   $\text{\textcircled{▶}}$

3000K | >80CRI | 720lm | clear glass  
dark grey texture

724474D4

### ALWAYS USE

base 230 910033D0  
base 600 910036D0  
base 800 910038D0  
invisible fixation base 230 910032D0

### OPTIONAL, (ORDER SEPARATELY)

ground spike for invisible base 230 90013104  
ground fixation for base 230 | 600 | 800 90013303

base plate dimensions

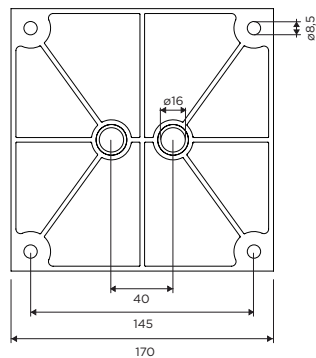

invisible fixation dimensions

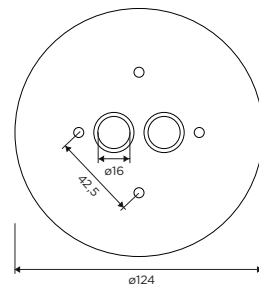

⑤

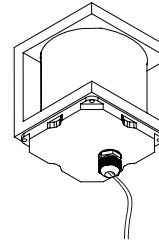

③

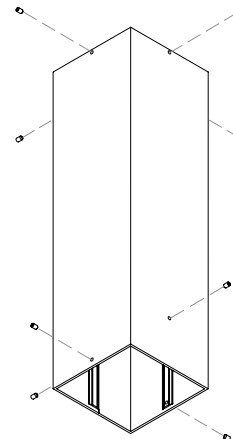

②

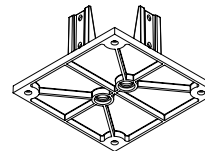

## DIMENSIONS

PALLUZ C 1.0

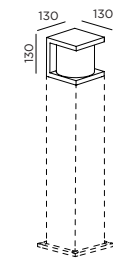

PALLUZ C 2.0

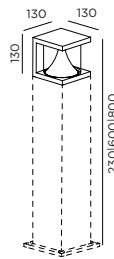

## MOUNTING INSTRUCTION

- ① Remove the lower part of the base\*
- ② Fixate the lower part on the ground with screws
- ③ Fixate the base to the lower part

## POWER CONNECTION

- ④ Connect the wires with the waterproof connections

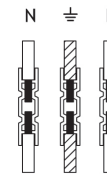

- ⑤ Attach the head of the fixture on the base

\* DO NOT COVER BASE (moss, bark, ...).  
Permanent moisture & possible chemical processes from eg.  
fertilization might lead in some combinations to a corrosive reaction.



**WEVER & DUCRÉ**  
LIGHTING

[www.weverducre.com](http://www.weverducre.com)

Wever & Ducre bvba Kwadestraat 153 bus 2.1 8800 Roeselare

**INSTALLATION  
INSTRUCTIONS**